

REVISION HISTORY				
ZONE	REV	DESCRIPTION	DATE	APPROVED
All	1	Released	5/11/2018	RLC

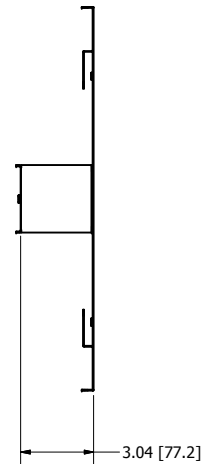

TILE BRIDGE

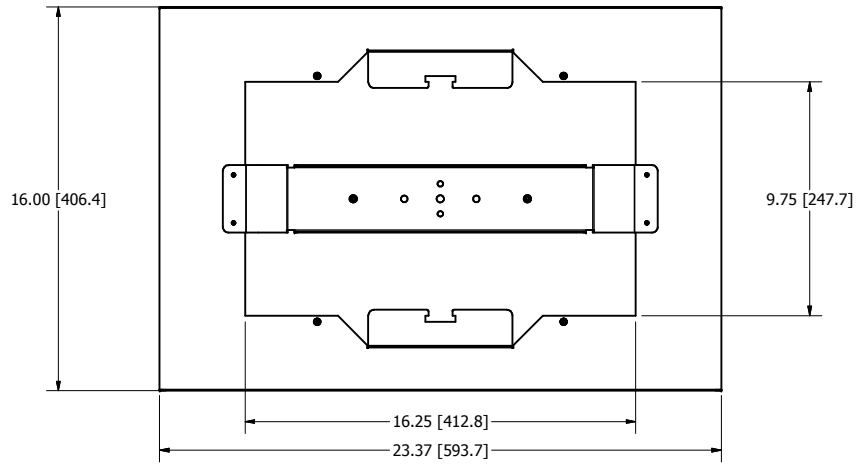
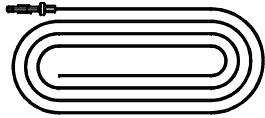
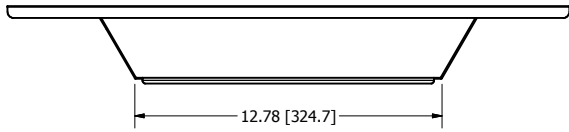
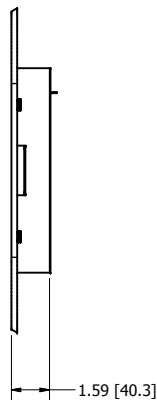
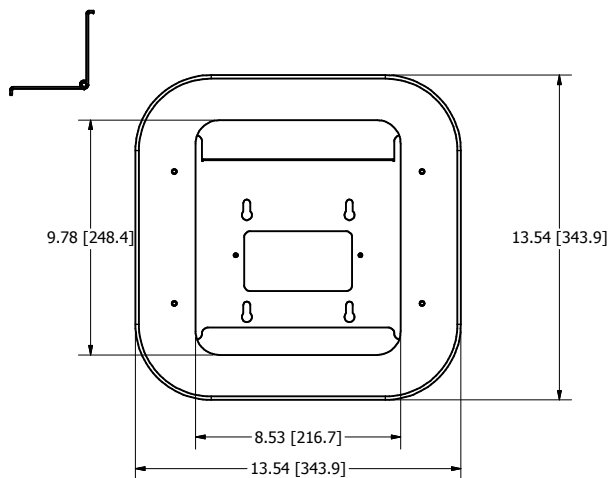

TRIM

NOTES:

- Weight: 6 lbs.
- Material: 20 Ga. Galvanized Steel Bridge
14 Ga. White Powder Coated Steel Trim
- Includes:
 - (1) Tile Bridge
 - (1) Trim
 - (2) Required Hardware
 - (1) Speed Link Retention Wire

NOTE: All materials used in the construction of Oberon products must be RoHS compliant and meet RoHS2 Directive 2011/65/EU. Contact Oberon engineering if RoHS compliant materials are not available.

DRAWN RLC	5/11/2018	Oberon, Inc. - 1315 S. Allen St. - State College, PA 16801		
CHECKED RLC	5/11/2018	TITLE		
QA		Model 1040-COAP4800		
MFG RLC	5/11/2018	SIZE C	DWG NO 3582	REV 1
APPROVED RLC	5/11/2018	SCALE	SHEET 1 OF 1	
TOLERANCE:	.0 = +/- .030 .00 = +/- .015 .000 = +/- .005			